

City of Hazelwood 2015 International Residential Code Deck Details

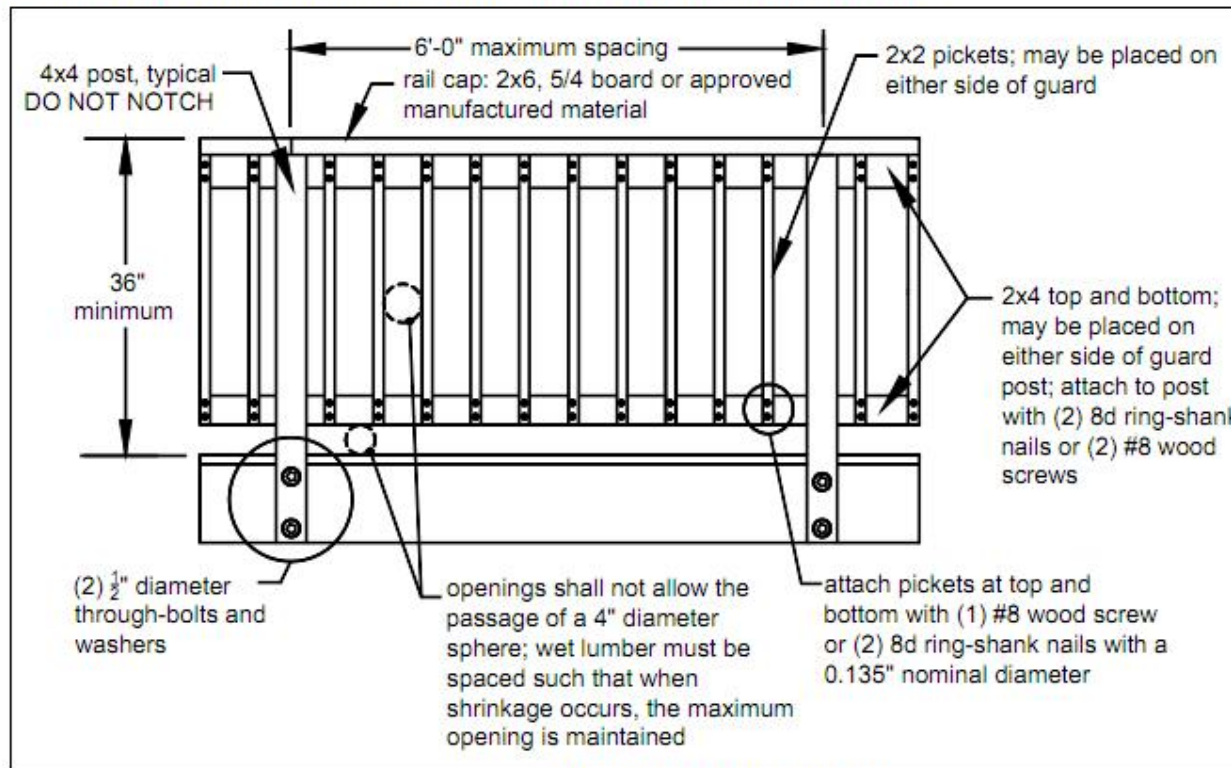

GUARD REQUIREMENTS

All decks greater than 30" above grade are required to have a guard. If you are providing a guard when one is not required, it must meet these requirements. All guards shall be constructed in strict conformance with the details herein; any deviations require a plan submission.



TYPICAL GUARD DETAIL



**PROHIBITED NOTCHING
AT GUARD POSTS**

UNLESS 6" x 6" POST

STAIR AND HANDRAIL DETAIL

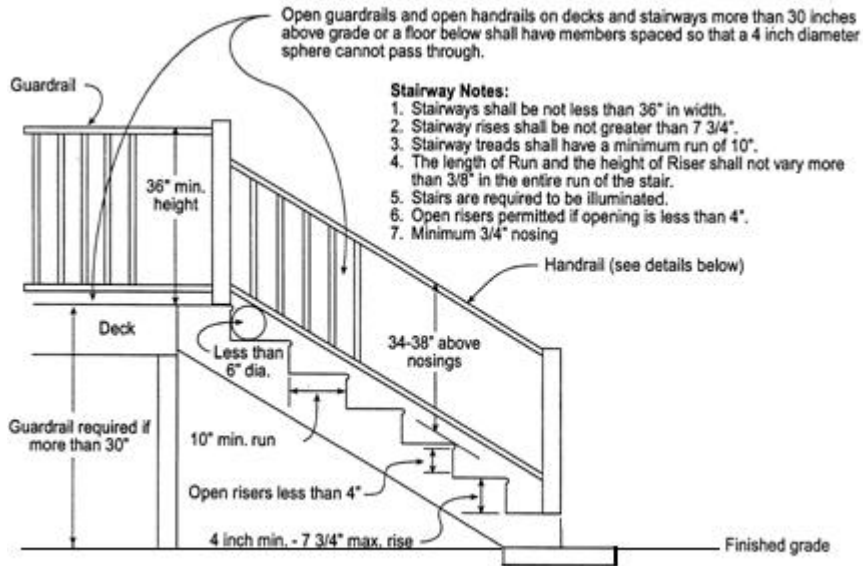

TYPICAL STAIR

Stringers attached at top with non-corrosive metal straps or joist hangers and bottom on concrete pad.

Stringers shall be a minimum of 3 - 2" x 12"

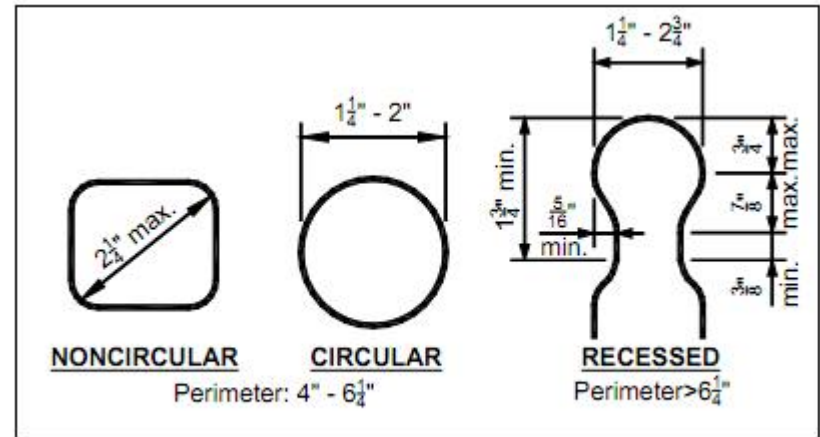

HANDRAIL GRASPABILITY TYPES/GEOMETRY

GRASPABLE HANDRAIL

(Required minimum on one side)

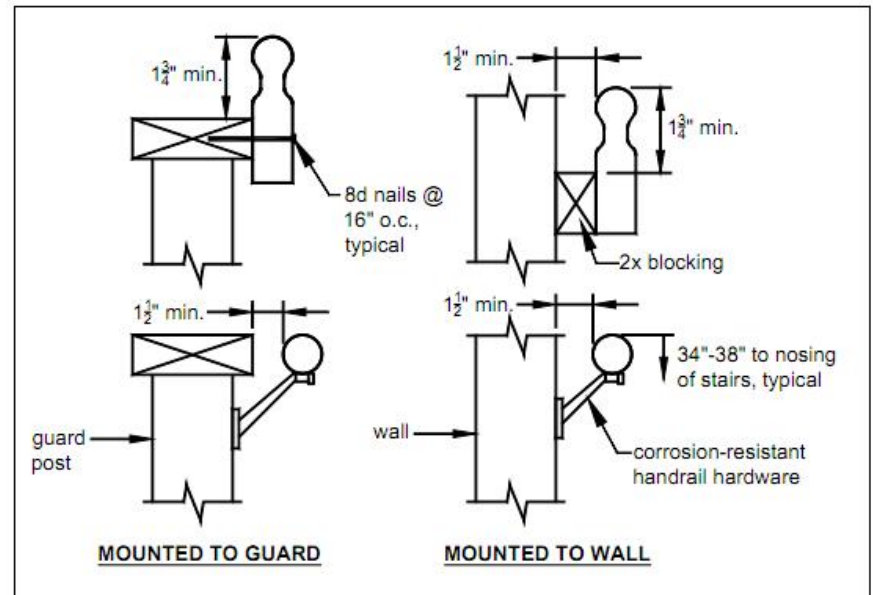

HANDRAIL REQUIREMENTS

PIER/POST DETAIL

Minimum 10" diameter and 30" below grade

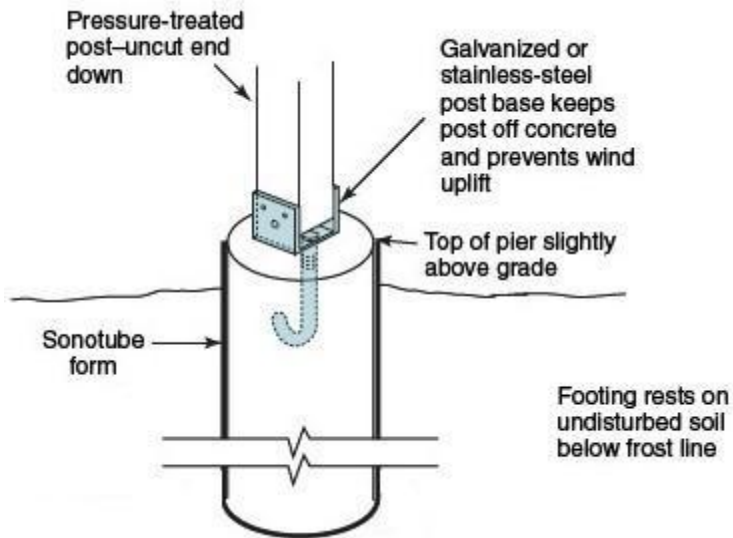

6" x 6" POSTS REQUIRED

(Decks 8' or more above grade)

FLASHING DETAIL

(Non-Corrosive)

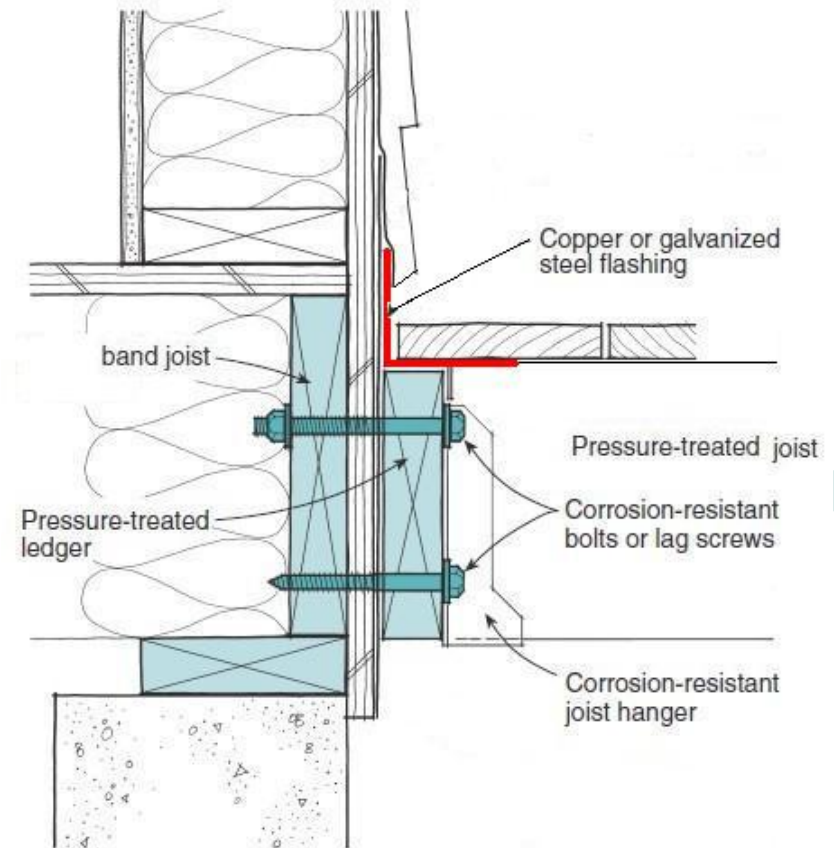

LEDG

½" MINIMUM LEDGER BOLTS SPACING (staggered top/bottom)

- Deck Spans up 10'-0" - Bolts 18" on Center
- Deck Spans up 10'-1 to 12'-0" - Bolts 15" on Center
- Deck Spans up 12'-1 to 14'-0" - Bolts 13" on Center
- Deck Spans up 14'-1 to 16'-0" - Bolts 11" on Center
- Deck Spans up 16'-1 to 18'-0" - Bolts 10" on Center

LEDGER LATERAL DECK ATTACHMENT DETAIL

Minimum Two (2) per deck within 24" of each end

Each device shall have an allowable stress design capacity of not less than 1500lb.

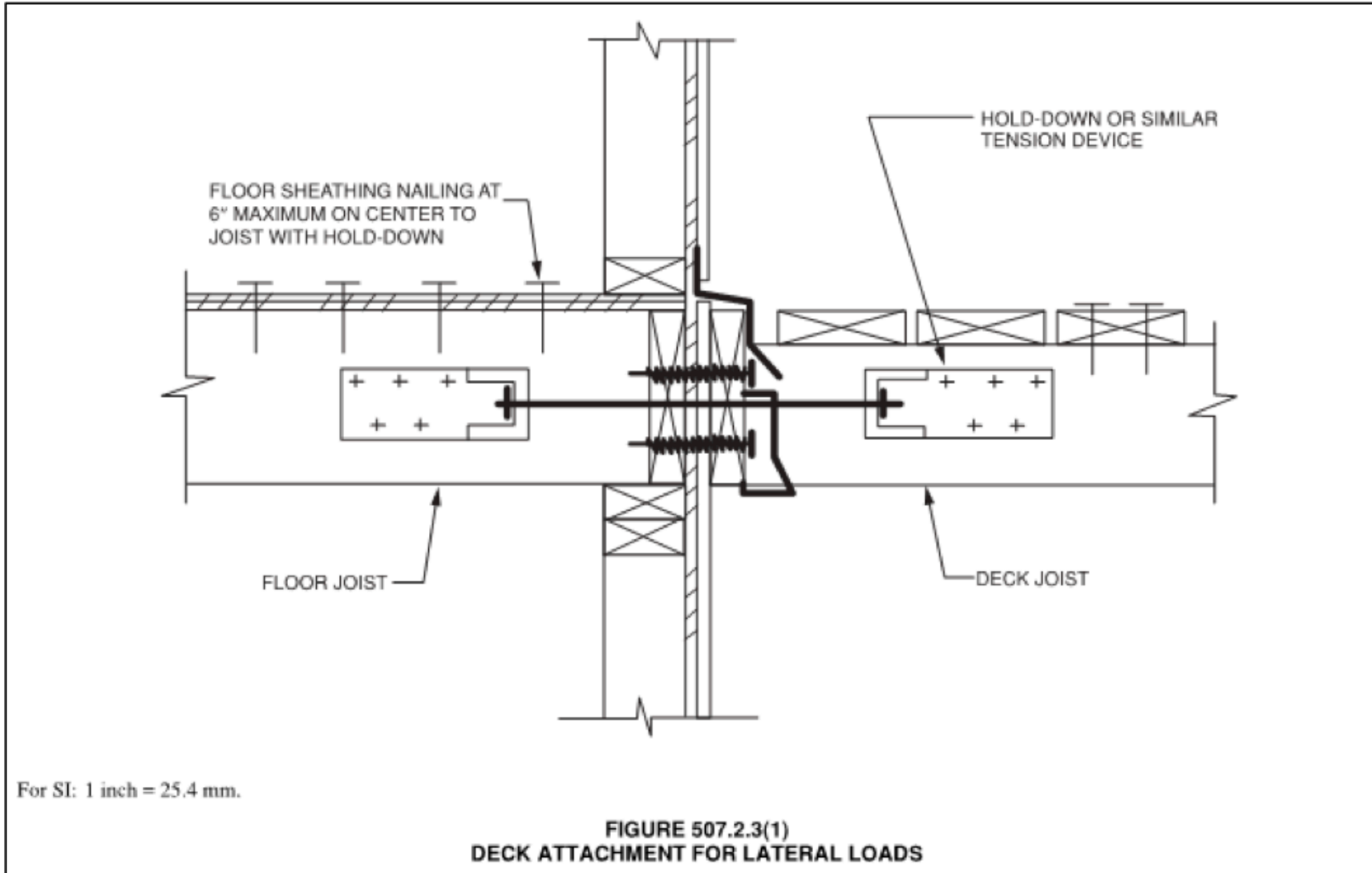

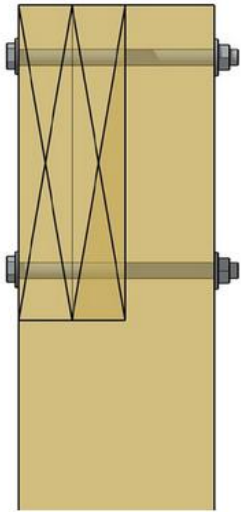

6"x 6" POST BEAM DETAIL

All posts/beams attached with two 1/2" through bolts.

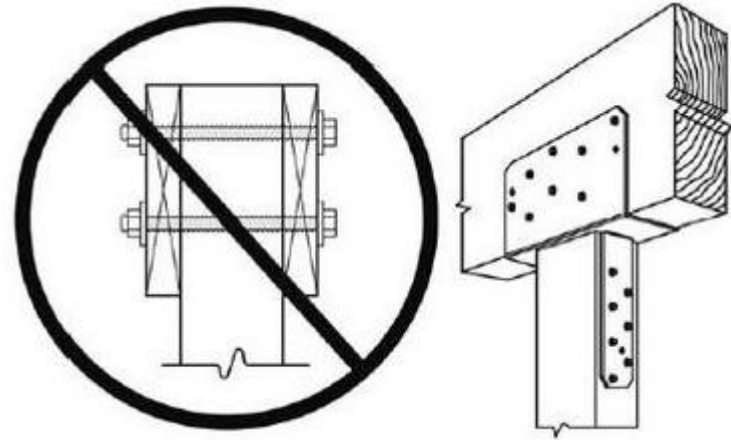

4"x4" POST BEAM DETAIL

Typical 4"x4" to BEAM connection

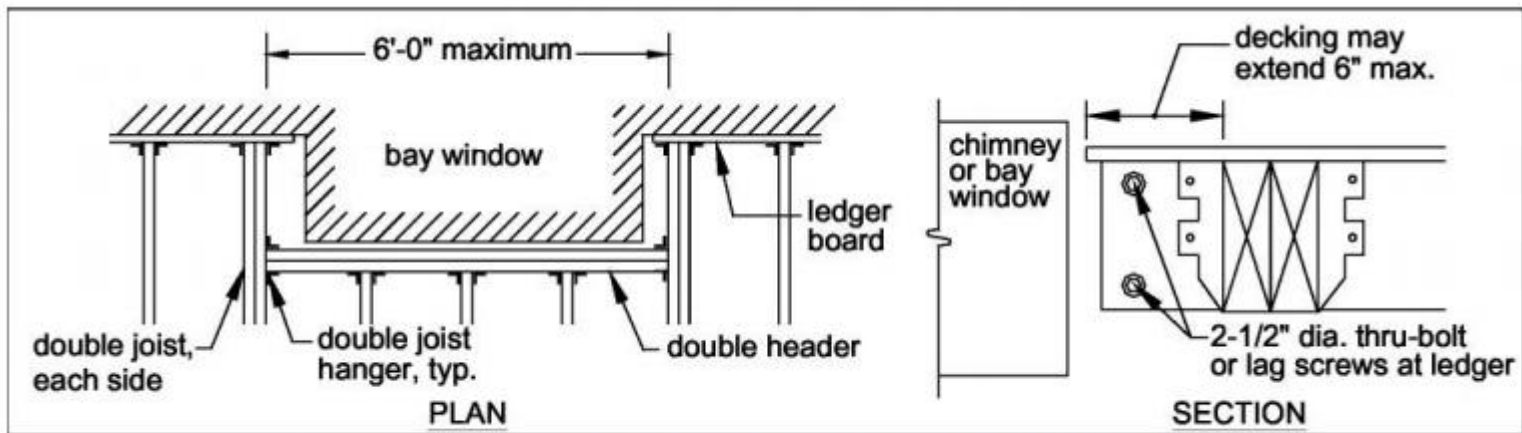

REQUIREMENTS FOR FRAMING AT BAY WINDOW

DOUBLE JOIST "H" FRAME

Required at all bay windows or cantilevers

CANTILEVER DESIGN WHEN PERPENDICULAR AND LOAD CARRIED BY INTERIOR DOUBLE JOISTS (Minimum 2/3 in 1/3 out)

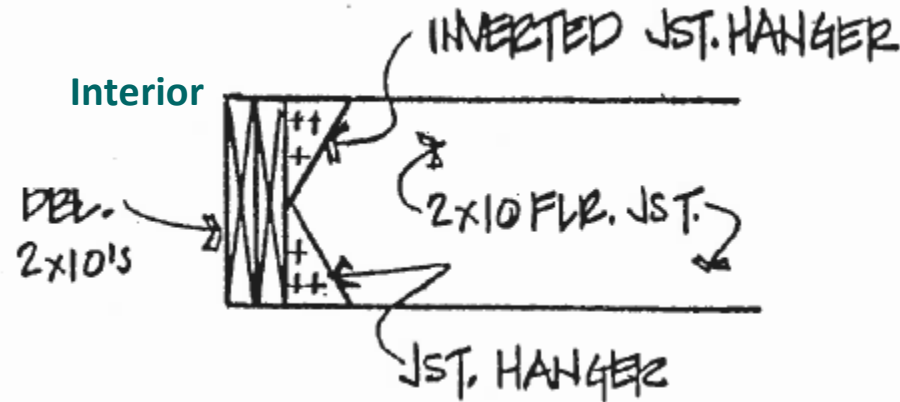

SPAN TABLE (Treated Yellow Pine)

JOIST SPAN TABLE		BEAM SPAN TABLE	
Maximum Joist Span		Maximum Beam Span	
2x6s @ 16"	9' 0"	2—2x6s	6' 11"
2x6s @ 24"	7' 7"	2—2x8s	8' 9"
2x8s @ 16"	11' 10"	2—2x10s	10' 4"
2x8s @ 24"	9' 8"	2—2x12s	12' 2"
2x10s @ 16"	14' 0"		
2x10s @ 24"	11' 5"		
2x12s @ 16"	16' 6"		

****ALL OVERHEAD ELECTRICAL WIRES****

Electrical Wires over the deck and over an area projecting three (3) feet horizontally from the deck must be at least 10 feet above finished deck.

ALL WOOD TO BE PRESSURE TREATED OR NATURALLY DURABLE

ALL FASTENERS AND METAL TO BE CORROSIVE RESISTANT

**THESE DETAILS MAY NOT INCLUDE ALL DECK REQUIREMENTS
AND SHOULD ONLY BE USED AS A GUIDE.**

Protecting the Health, Safety and Welfare of our City!